

Roger Select™

Quick setup guide | Schnellstartanleitung

Guide d'installation rapide | Snel aan de slag



roger



A Sonova brand

PHONAK
life is on

1

Charging / Aufladen
Charger / Laden

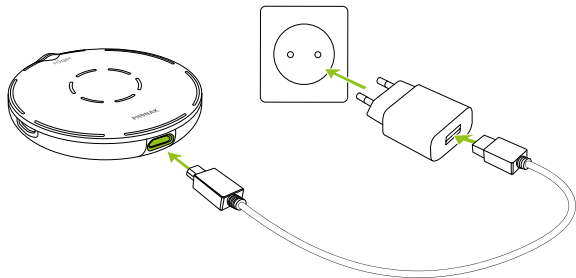

2

Switching on / Einschalten
Mettre en marche / Inschakelen

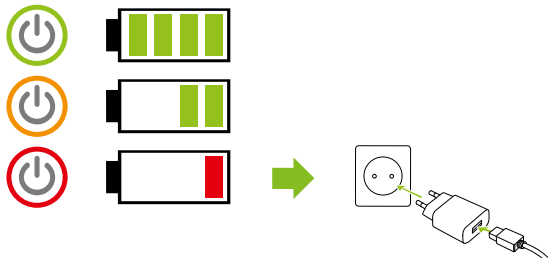
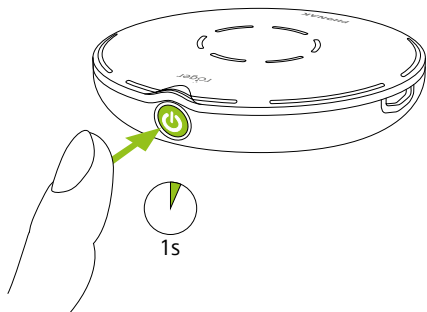

3

Connecting / Verbinden
Connector / Verbinden



or
oder
ou
of

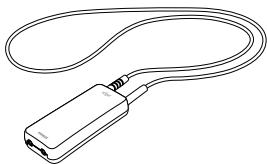

10 cm / 3 inch

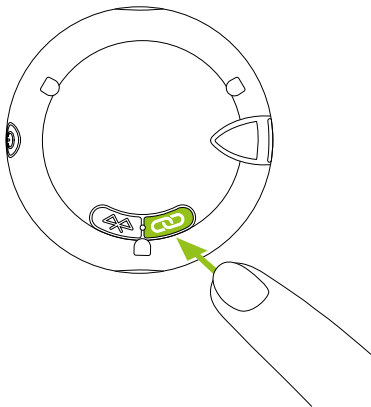

4

Use on the table / Verwendung auf dem Tisch
Utilisation sur la table / Gebruik op tafel

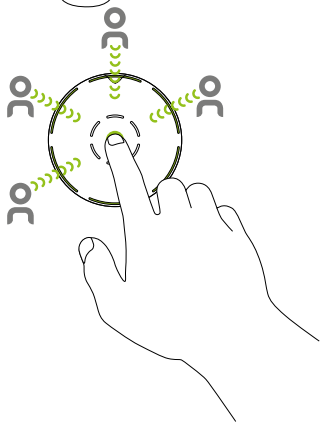
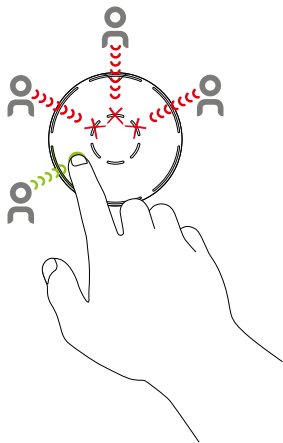

5

Use with a speaker / Verwendung mit einem Sprecher
Utilisation avec un locuteur / Gebruik met een spreker

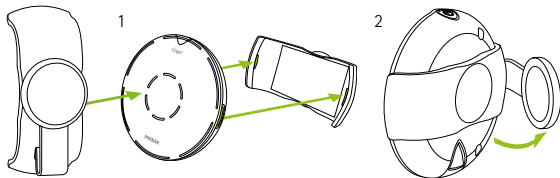
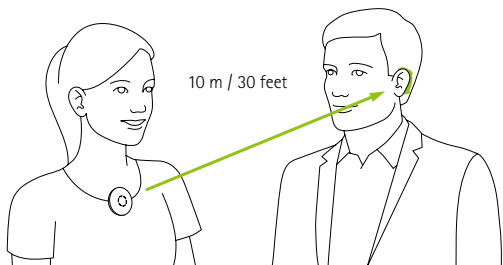

or / oder / ou / of

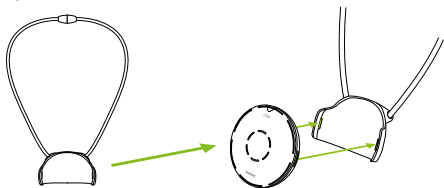

6

Use with the TV / Verwendung mit dem Fernseher
Utiliser avec le téléviseur / Gebruik met de televisie

1

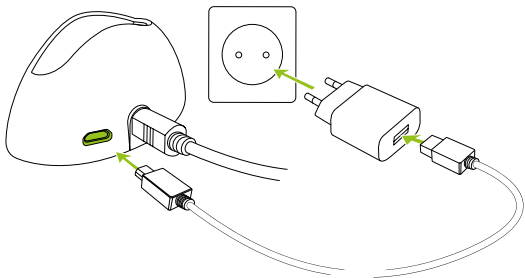

2

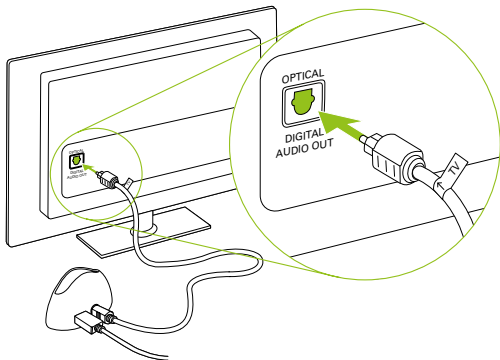

3

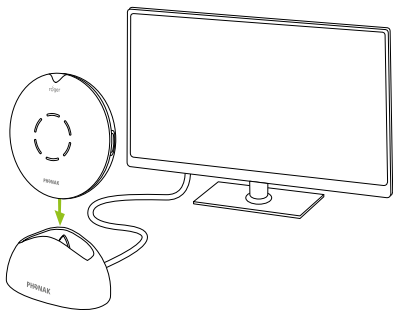

4

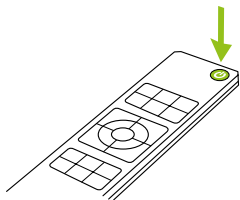

7

Use with an audio device / Verwendung mit einem Audiogerät / Utiliser avec un appareil audio / Gebruik met een audio-apparaat

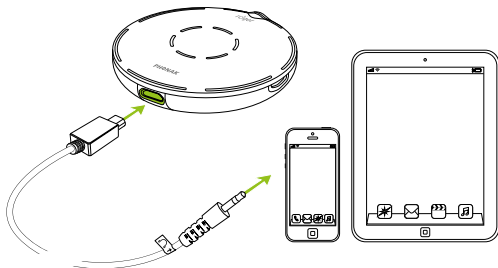

8

For further information, please refer to the User Guide.
Weitere Informationen zur Anwendung finden Sie in der Gebrauchsanweisung.

Pour plus d'informations, veuillez vous référer aux instructions d'utilisation.

In de gebruiksaanwijzing vindt u meer gedetailleerde informatie.





Manufactured under license from Dolby Laboratories.

Dolby, Dolby Audio, and the double D-symbol are trademarks of Dolby Laboratories.



Sonova Communications AG
Herrenschwandweg 4
CH-3280 Murten
Switzerland

www.phonak.com

